

# MiG-25 "Foxbat" Park Jet

by: Ben Song

Wing Span: 32in

Length: 53 1/4in

Wing Area: 387sqin

Wing Loading: 9oz/sqft

C of G: 3 3/8in behind LE wing root at fuselage

Servos: 3 (aileron x2, elevator x1)

Motor: BP-12 brushless outrunner

Batt: 2000mah 3s1p (10C) lipoly

Max Amps: 12A

Control Throws:

Aileron: 3/8" up and down (-35% expo)

Elevator: 3/4" up and down (-40% expo)

If you enjoy these plans, please consider making a  
\$10 PayPal donation to [benjsong@hotmail.com](mailto:benjsong@hotmail.com)

4/15/06 v2.1

Copyright 2006

Page 2 of 2



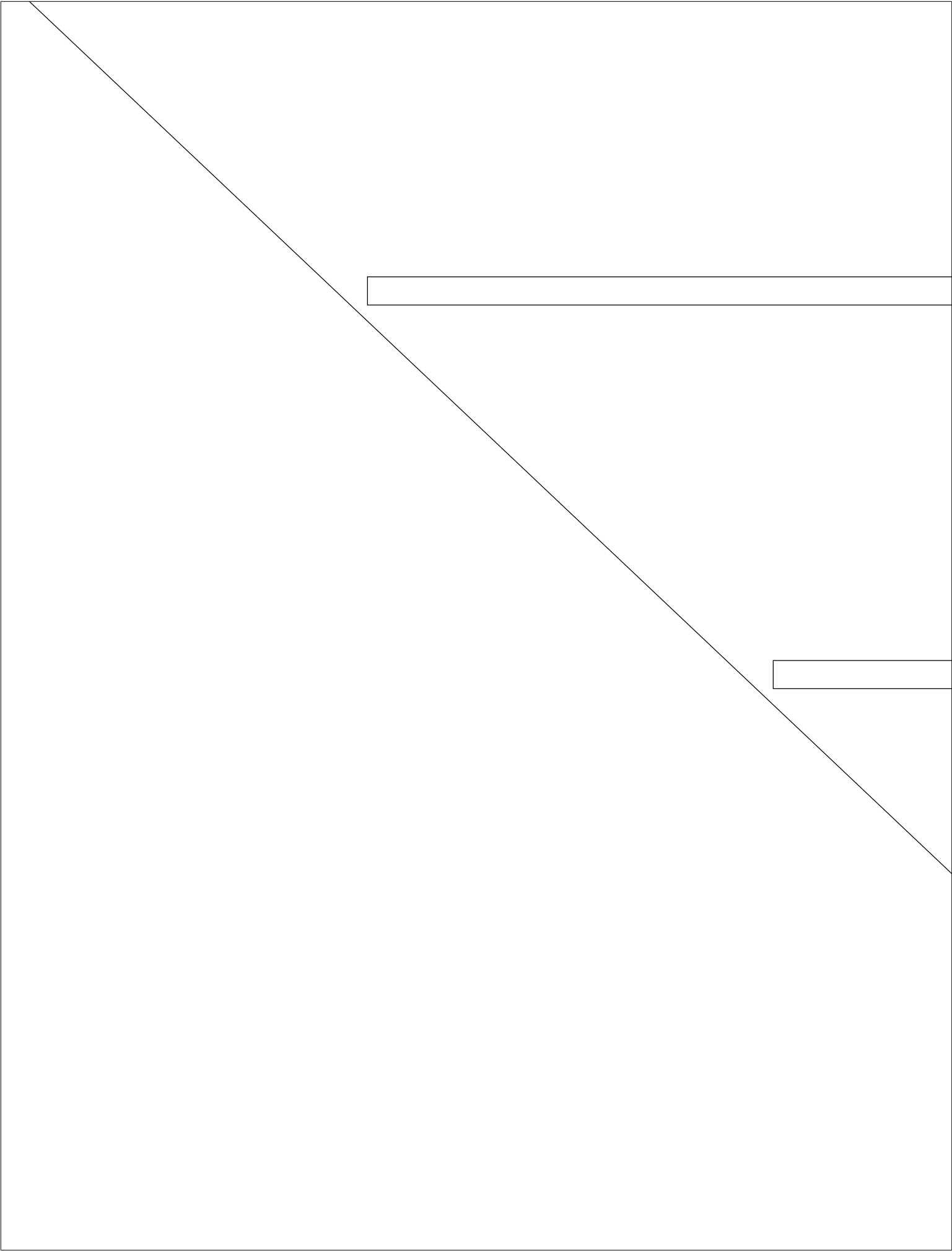

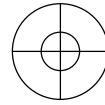

Wing  
Make 1

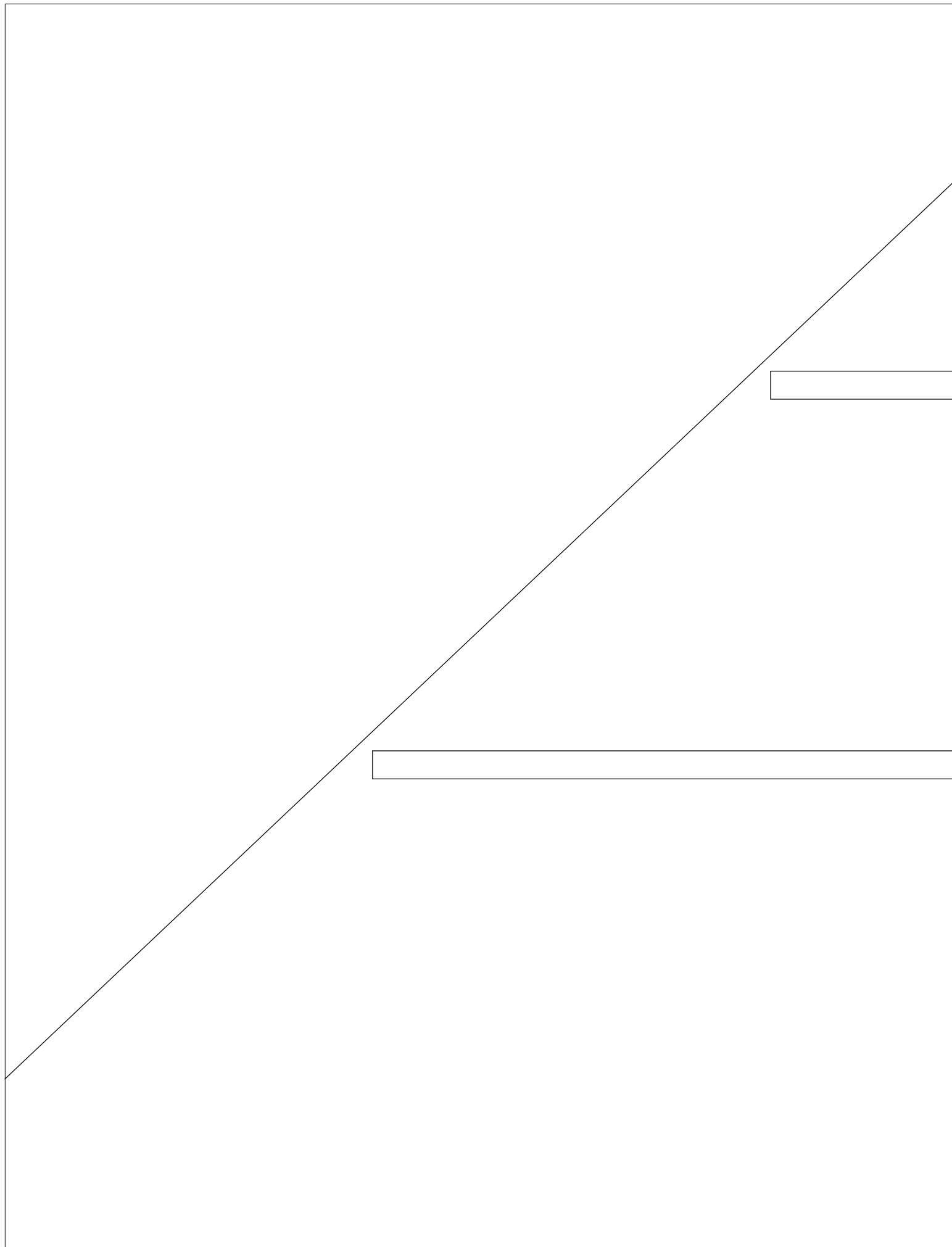



Fin Guide  
Slant-cut

Aft Top Fuse  
Make 1



Fin Guide  
Slant-cut



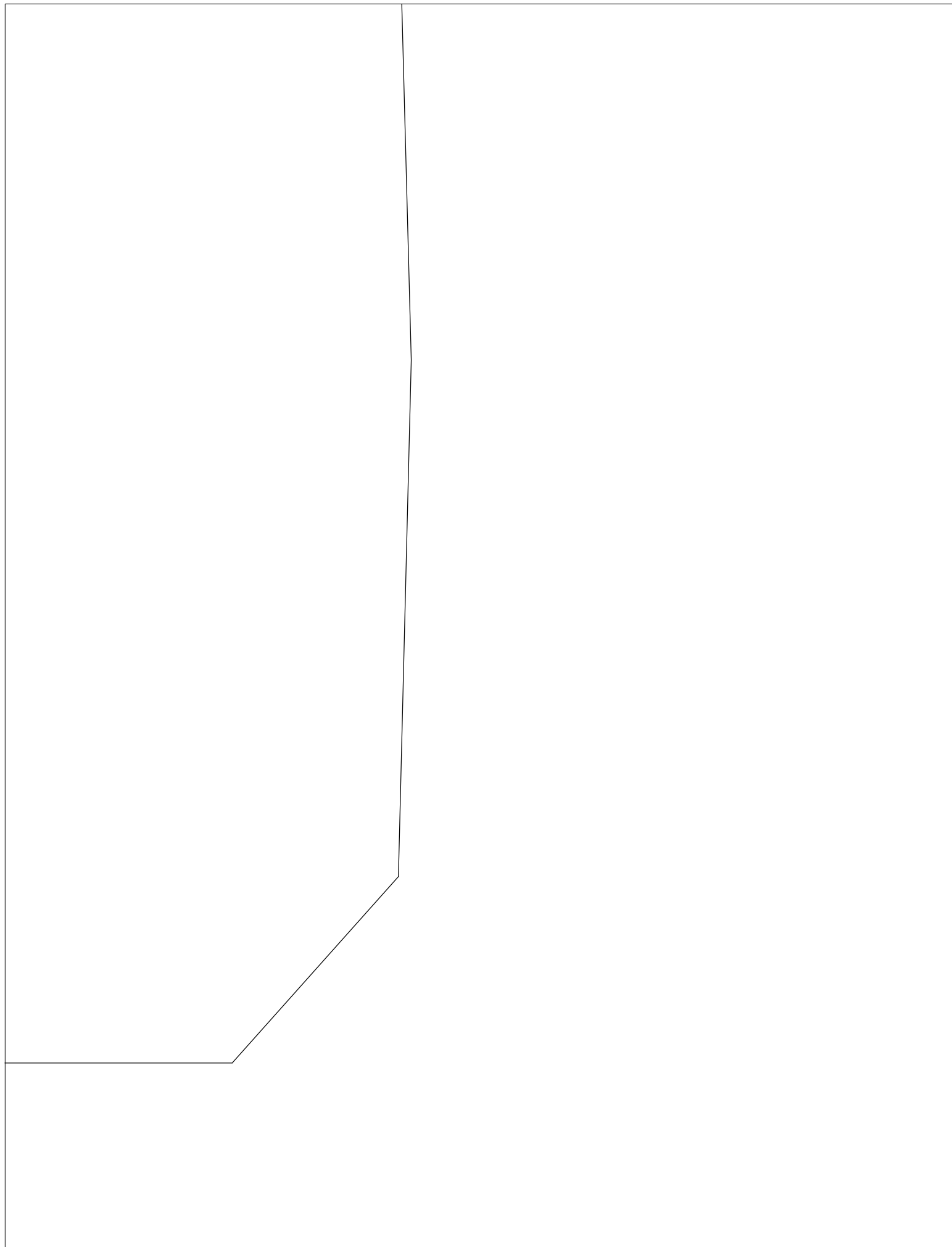

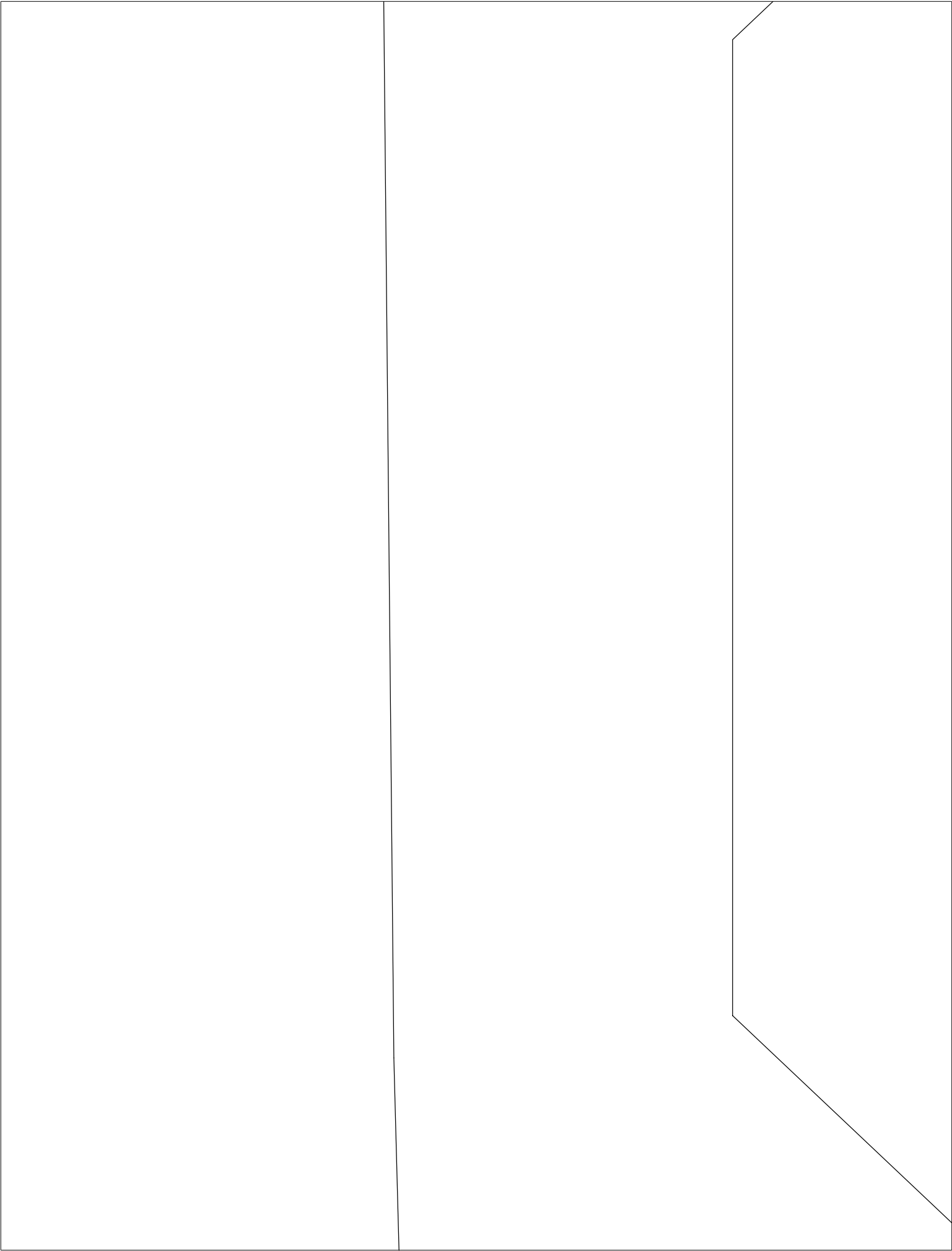

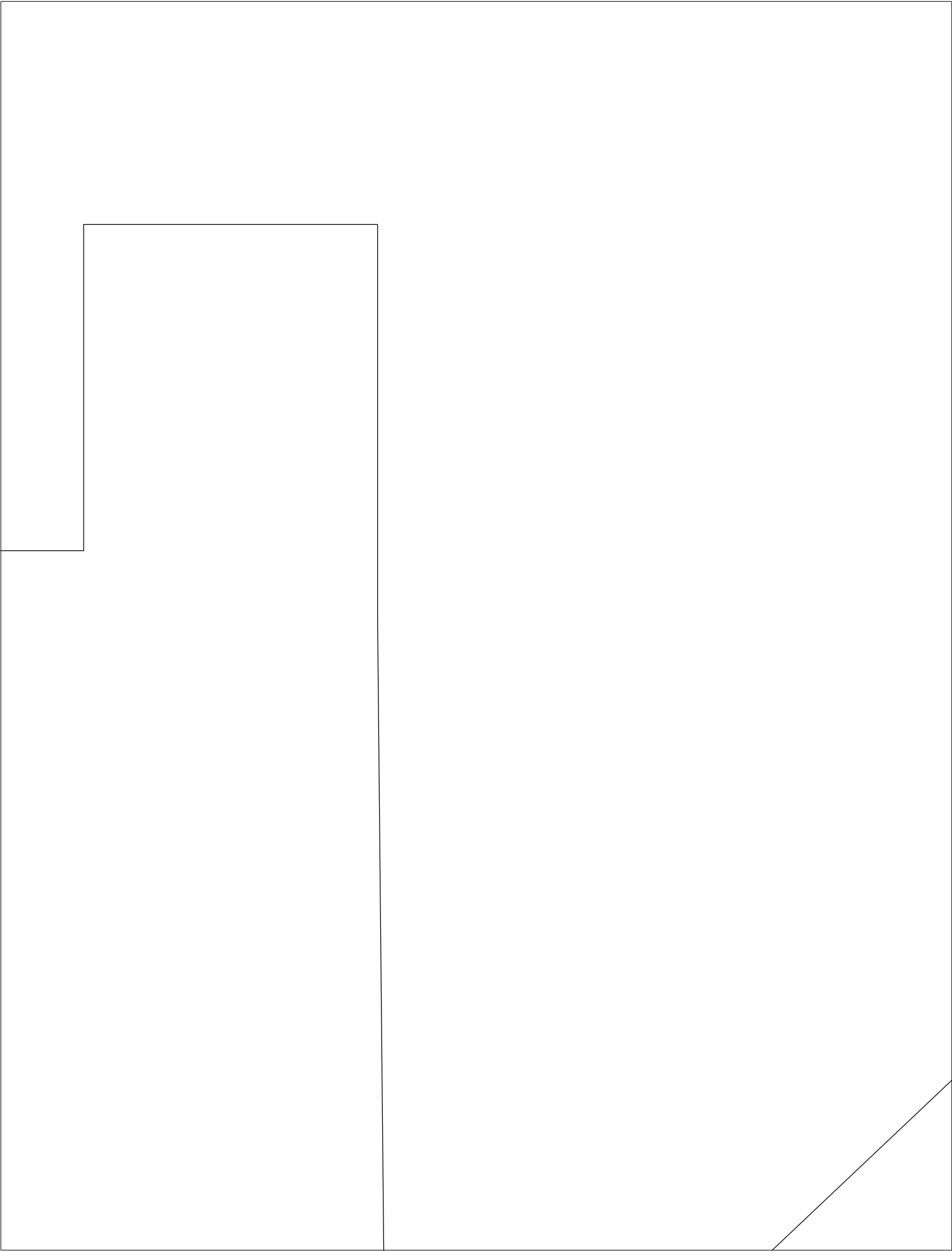



Fin Guide  
Slant-cut

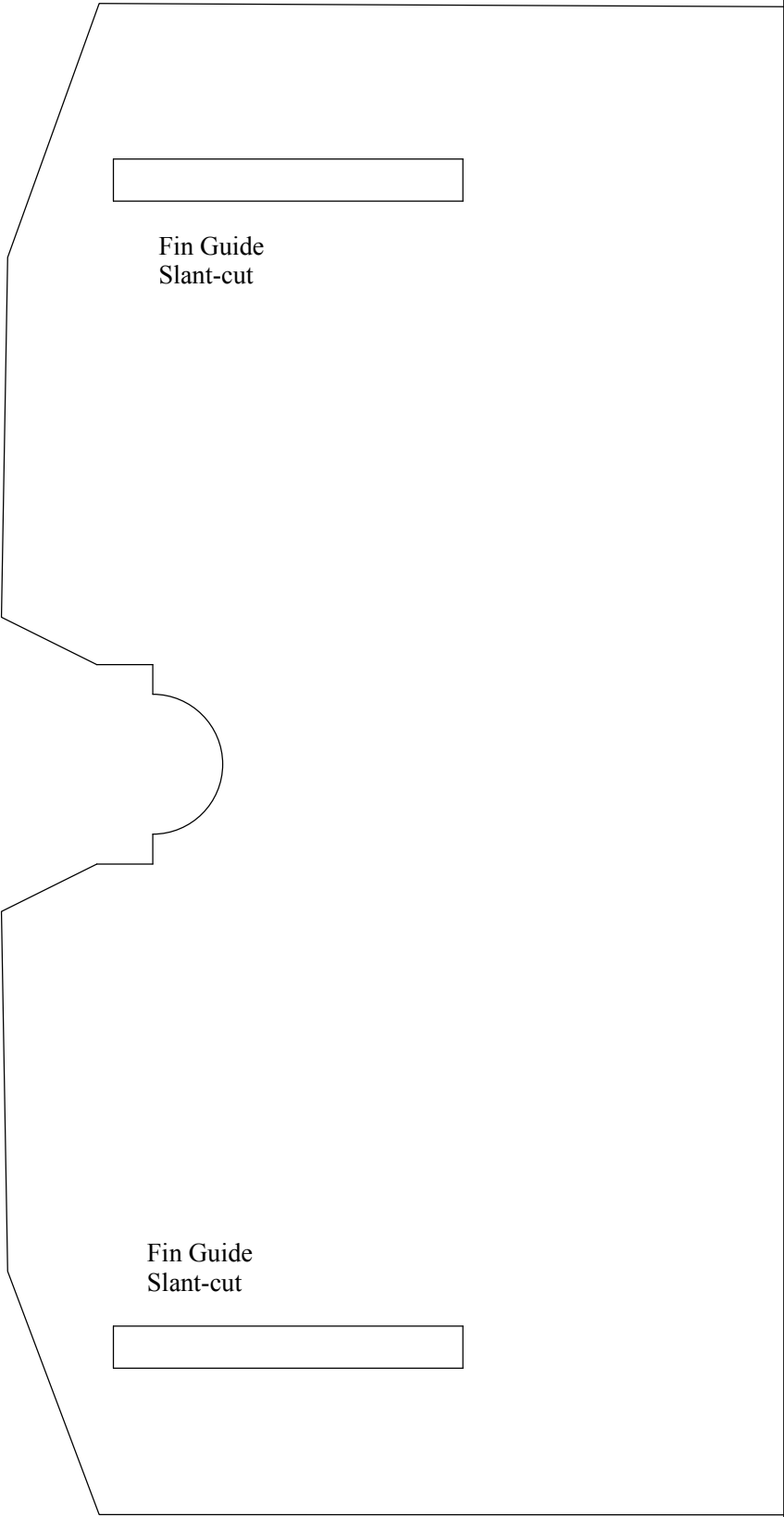



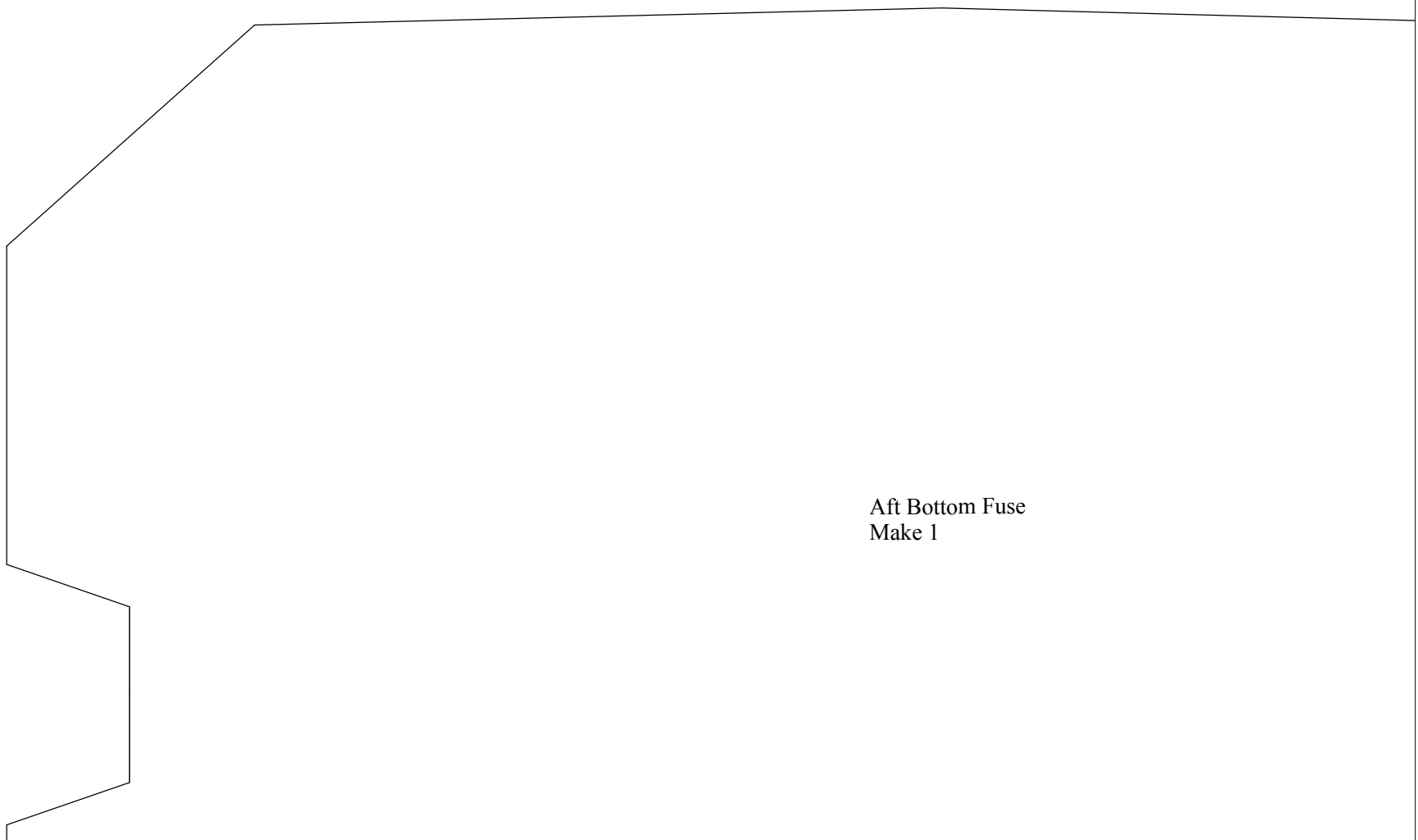

Aft Bottom Fuse  
Make 1

--	--

